

John Adams®

# GLOWPAD

**Bring your pictures to life!**

## Contents

- GLOWPAD light-up tablet
- 2 x Neon marker pens

## Installing or replacing batteries

Ask an adult to install or replace batteries – see back page for Battery Information.

## Getting started

Draw or write on the GLOWPAD drawing surface using the 2 neon marker pens included.

These marker pens are to be used on the GLOWPAD only.

Ensure the cap is firmly put back onto the marker pen when not in use to prevent the ink from drying out.

If marker pens are dry, gently rub pen tip on GLOWPAD drawing surface, recap and leave overnight.

**For replacement marker pens only use chalk marker type pens.**

## Begin your light show

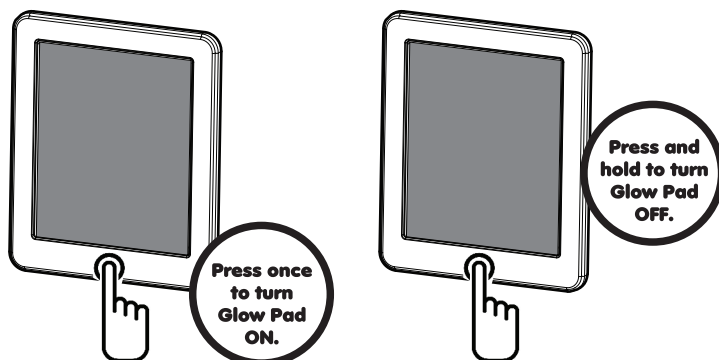

To change colours on your GLOWPAD simply press ON and OFF button, each additional click will change the colour of the lighting.

The GLOWPAD has 7 single colour modes plus one colour changing mode.

## Cleaning your GLOWPAD

After each use erase your artwork using a damp tissue or cloth (not wet).

Clean gently and carefully to avoid scratching the GLOWPAD surface.

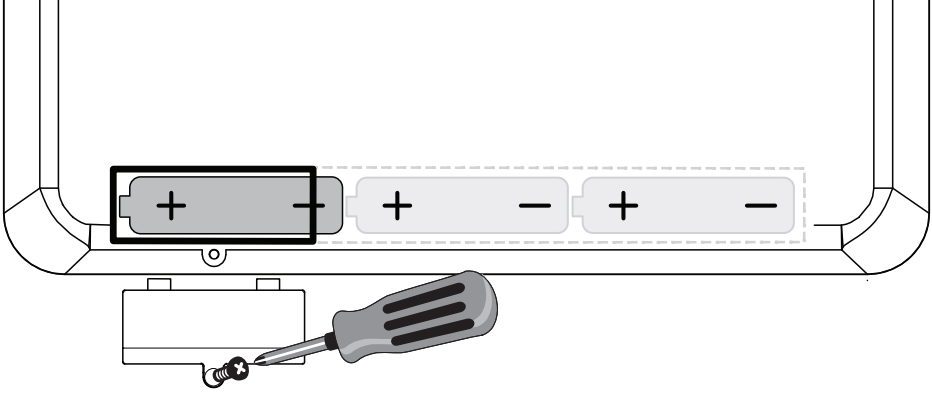

## BATTERY INFORMATION

- GLOWPAD requires 3 x AAA batteries (not supplied).
- We recommend alkaline batteries for optimum performance.
- An adult should install the batteries and take note of the following - ensure the GLOWPAD is turned off, then open the cover on the base of the pad using a cross head screw driver. Then remove the battery cover. Next insert the batteries making sure the + and – signs on the batteries are aligned with the corresponding + and – signs inside the compartment. Firmly screw the battery cover back in place.
- Do not recharge non-rechargeable batteries.
- Rechargeable batteries are to be removed from the toy before charging them.
- Rechargeable batteries are only to be charged under adult supervision.
- Only batteries of the same or equivalent type, as recommended, are to be used.
- Insert batteries in the correct polarity.
- Remove exhausted (used) batteries from the toy.
- Remove batteries from the toy if it is not going to be used for a long period of time.
- Do not short-circuit the supply terminals.
- Batteries should be replaced by an adult.
- Do not attempt to power battery products from the mains supply and do not insert connecting wires into electrical socket outlets.
- Dispose of used batteries at a recycling point. Never dispose of batteries in fire.



• **Disposal of old electrical and electronic equipment.** This symbol on the product or its packaging indicates that this product should not be treated as household waste. Instead it should be handed over to the appliance collection point of a recycling centre for electronic and electrical equipment.

For more detailed information about recycling of this product, contact your local Civic Office, your household waste disposal service or the place you purchased this item from.

**WARNING!** Not suitable for children under 36 months. Choking hazard - contains small parts. Adult supervision required. Avoid skin contact with pen ink. Wash skin with soap and water to remove any incidental skin contact. Marker pens may stain, please protect clothes and the working area.

©2016 John Adams Leisure Ltd. Made in China. John Adams Leisure Ltd. is constantly endeavouring to improve quality standards and therefore colours, sizes and contents may sometimes vary from those shown. Packaging and leaflets printed on recycled paper wherever possible. Please retain this information for reference.

John Adams Leisure Ltd, Marketing House, Blackstone Road, Huntingdon, Cambridgeshire, PE29 6EF, England.  
For customer services call 01480 414361 or email [customerservices@johnadams.co.uk](mailto:customerservices@johnadams.co.uk)

**To see more of our range why not visit [www.johnadams.co.uk](http://www.johnadams.co.uk)**